



NOTES

GENERAL NOTES:

1. ALL DRAWINGS TO BE CHECKED BY CONTRACTOR ON SITE AND ENGINEER BEFORE COMMENCEMENT OF WORK.
2. ALL DIMENSIONS AND LEVELS ARE IN METRES UNLESS NOTED OTHERWISE.
3. ALL LEVELS ARE IN METRES AND ARE RELATED TO ORDNANCE DATUM. CO-ORDINATES RELATE TO NATIONAL GRID.
4. CONTRACTOR SHALL SATISFY HIMSELF AS TO THE ACCURACY OF INFORMATION ON SITE PRIOR TO COMMENCEMENT OF WORK ON SITE.
5. ALL WASTEWATER INFRASTRUCTURE INCLUDING FOUL SEWERS, CONNECTIONS AND MANHOLES TO BE CONSTRUCTED IN ACCORDANCE WITH THE HIGH WATER CONSTRUCTION AND DEVELOPER SERVICES WASTEWATER INFRASTRUCTURE STANDARD DETAILS DOCUMENT IN USE.
6. FOUL SEWER PIPE MATERIAL TO BE IN ACCORDANCE WITH SECTION 1.1 OF THE HIGH WATER CODE OF PRACTICE WHICH IS REPRODUCED IN SPECIFICATION APPROX 5.1.
7. SURFACE WATER SEWERS TO BE CONSTRUCTED TO CLASS 4 CONCRETE TO EN 1245 & 5.2004 IN ACCORDANCE WITH THE GREATER BIRMINGHAM CODE OF PRACTICE FOR DRAINAGE WORKS.
8. LOCATION AND DEPTH LEVELS OF EXISTING MANHOLES AND OUTFALL POINTS TO BE VERIFIED BY CONTRACTOR PRIOR TO COMMENCEMENT OF DRAINAGE WORKS UNLESS OTHERWISE STATED.
9. ALL COVER LEVELS TO MATCH FINISHED ROAD/VERGEE/PATHWAY/CYCLETRACK LEVELS UNLESS OTHERWISE STATED.
10. ALL SURFACE WATER DRAINAGE WORKS CONNECTIONS TO COMPLY WITH THE REQUIREMENTS OF THE LOCAL AUTHORITY.
11. CONTRACTOR TO INCLUDE FOR CCTV SURVEY OF ALL FOUL & SURFACE WATER SEWERS (DRAINAGE) UPON COMPLETION OF SAME.
12. MANHOLE COVERS IN LANDSCAPED AREAS TO BE SURROUNDED BY A CONCRETE SLAB 200mm BOUND AND 100mm DEEP FORMED WITH C20/25 CONCRETE 10MM AGGREGATE SIZE BEDDED IN CLASS 6A MATERIAL.

SERVICES LEGEND

- PROPOSED SITE BOUNDARY
- EXISTING SURFACE WATER SEWER
- PROPOSED SURFACE WATER SEWER AND MANHOLE
- PROPOSED SURFACE WATER RECEPTION CHAMBER (STD-3M-13) AND 100mm² HOUSE DRAIN
- PROPOSED 160mm OD PE100 FUL RESIST MAN SERVICES SEPARATION DISTANCE/AVILEAVE
- EXISTING LEVELS
- FINISHED FLOOR LEVEL
- GREEN ROOF SEDUM BLANKET OR SIMILAR APPROVED
- SEE INLET KEYS

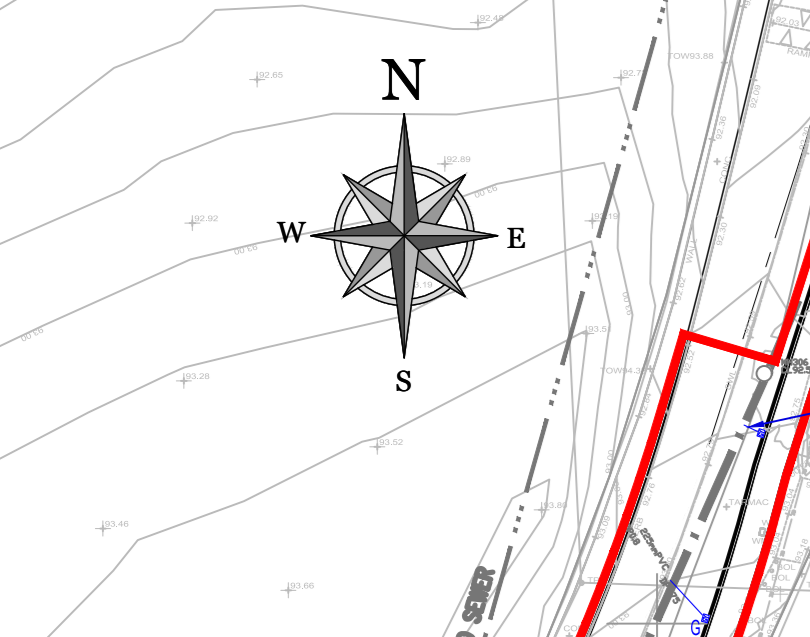

IMAGE 001 - FOUL PUMPING STATION EXAMPLE



IMAGE 002 - DETENTION BASIN EXAMPLE - PHASE 1 GRAYDON DEVELOPMENT

ORDNANCE SURVEY IRELAND LICENCE
No EN 0017921
© ORDNANCE SURVEY IRELAND GOVERNMENT OF IRELAND

PROJECT	13/06/22 STAGE 3 SHD	PIC	NOG
DATE	02/11/23 STAGE 2 SHD	DMF	NOG
BY		BY	2963

client approval: A - Approved with amendments, B - Approved with variations, C - Do not use

integrity: S2 - INFORMATION, PLANNING

DBFL Consulting Engineers
Structural & Mechanical Engineering
www.dbf.com

DBFL OFFICE: Phoenix House, Upper Orchard Quay, Dublin 1, D02 W716
DBFL OFFICE: 11, South Mall, Cork, T12 C7H1
DBFL OFFICE: 200, The Arcade, Harcourt Road, Dublin 2, D02 YN02

project ref: NEWCASTLE SOUTH
Drawing title: PROPOSED DRAINAGE LAYOUT
client: CAIRN HOMES PROPERTIES LTD
designed by: [blank] / author: [blank] / scale: 1:500 / sheet size: A3
drawing no: 210026-DBFL-CS-SP-DR-C-1201 / P02